

# Take-up housing units

For linear motion  
With grub screws  
in inner ring

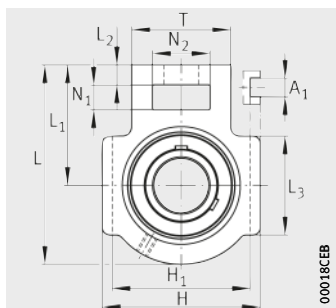

UCT

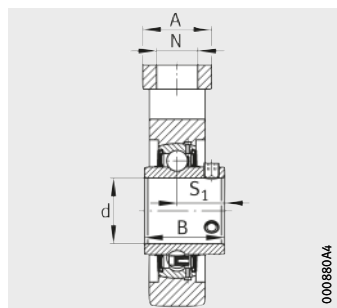

UCT

**Dimension table** · Dimensions in mm and *inch*

Designation	Mass m ≈kg	Dimensions		L	L <sub>1</sub>	L <sub>2</sub>	L <sub>3</sub>
		d					
		mm	<i>inch</i>				
UCT201	0,77	12	–	94	61	10	51
UCT201-08	0,77	12,7	1/2				
UCT202-09	0,76	14,288	9/16				
UCT202	0,75	15	–				
UCT202-10	0,75	15,875	5/8				
UCT203	0,74	17	–				
UCT203-11	0,74	17,463	11/16				
UCT204-12	0,73	19,05	3/4				
UCT204	0,72	20	–	97	62	10	51
UCT205-13	0,84	20,638	13/16				
UCT205-14	0,83	22,225	7/8				
UCT205-15	0,81	23,812	15/16				
UCT205	0,8	25	–				
UCT205-16	0,8	25,4	1	113	70	10	57
UCT206-17	1,27	26,988	1 1/16				
UCT206-18	1,25	28,575	1 1/8				
UCT206	1,23	30	–				
UCT206-19	1,23	30,162	1 3/16	129	78	13	64
UCT206-20	1,2	31,75	1 1/4				
UCT207-20	1,64	31,75	1 1/4				
UCT207-21	1,61	33,338	1 5/16				
UCT207-22	1,58	34,925	1 3/8				
UCT207	1,58	35	–	144	88	16	83
UCT207-23	1,55	36,512	1 7/16				
UCT208-24	2,36	38,1	1 1/2				
UCT208-25	2,33	39,688	1 9/16	144	87	16	83
UCT208	2,32	40	–				
UCT209-26	2,46	41,275	1 5/8				
UCT209-27	2,42	42,862	1 11/16				
UCT209-28	2,38	44,45	1 3/4	149	90	16	86
UCT209	2,37	45	–				
UCT210-29	2,64	46,038	1 13/16				
UCT210-30	2,59	47,625	1 7/8				
UCT210-31	2,54	49,212	1 15/16				
UCT210	2,52	50	–	149	90	16	86
UCT210-32	2,5	50,8	2				

										Housing	Radial insert ball bearing
N	N <sub>1</sub>	N <sub>2</sub>	A	H	H <sub>1</sub>	A <sub>1</sub>	B	S <sub>1</sub>	T		
19	16	32	32	89	76	12	31	18,3	51	T204	UC201
											UC201-08
											UC202-09
											UC202
											UC202-10
											UC203
											UC203-11
											UC204-12
19	16	32	32	89	76	12	34,1	19,8	51	T205	UC205-13
											UC205-14
											UC205-15
											UC205
											UC205-16
22	16	37	37	102	89	12	38,1	22,2	56	T206	UC206-17
											UC206-18
											UC206
											UC206-19
											UC206-20
22	16	37	37	102	89	12	42,9	25,4	64	T207	UC207-20
											UC207-21
											UC207-22
											UC207
											UC207-23
29	19	49	49	114	102	16	49,2	30,2	83	T208	UC208-24
											UC208-25
											UC208
29	19	49	49	117	102	16	49,2	30,2	83	T209	UC209-26
											UC209-27
											UC209-28
											UC209
29	19	49	49	117	102	16	51,6	32,6	83	T210	UC210-29
											UC210-30
											UC210-31
											UC210
											UC210-32

# Take-up housing units

For linear motion  
With grub screws  
in inner ring

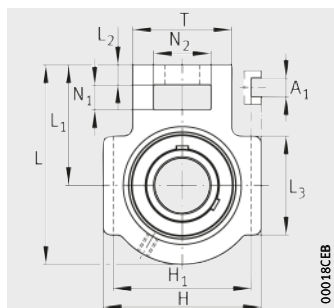

UCT

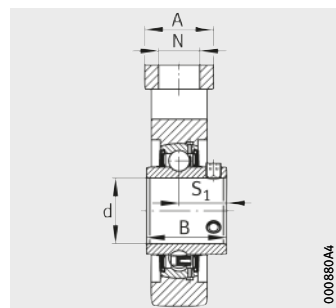

UCT

**Dimension table** (continued) · Dimensions in mm and *inch*

Designation	Mass m ≈ kg	Dimensions		L	L <sub>1</sub>	L <sub>2</sub>	L <sub>3</sub>
		d					
		mm	<i>inch</i>				
UCT211-32	3,98	<b>50,8</b>	<i>2</i>	171	106	19	95
UCT211-33	3,93	<b>52,388</b>	<i>2<sup>1</sup>/<sub>16</sub></i>				
UCT211-34	3,87	<b>53,975</b>	<i>2<sup>1</sup>/<sub>8</sub></i>				
UCT211	3,83	<b>55</b>	–				
UCT211-35	3,81	<b>55,562</b>	<i>2<sup>3</sup>/<sub>16</sub></i>				
UCT212-36	4,84	<b>57,15</b>	<i>2<sup>1</sup>/<sub>4</sub></i>	194	119	19	102
UCT212-37	4,77	<b>58,738</b>	<i>2<sup>5</sup>/<sub>16</sub></i>				
UCT212	4,71	<b>60</b>	–				
UCT212-38	4,69	<b>60,325</b>	<i>2<sup>3</sup>/<sub>8</sub></i>				
UCT212-39	4,61	<b>61,912</b>	<i>2<sup>7</sup>/<sub>16</sub></i>				
UCT213-40	6,68	<b>63,5</b>	<i>2<sup>1</sup>/<sub>2</sub></i>	224	137	21	121
UCT213	6,61	<b>65</b>	–				
UCT213-41	6,6	<b>65,087</b>	<i>2<sup>9</sup>/<sub>16</sub></i>				
UCT214-42	6,98	<b>66,675</b>	<i>2<sup>5</sup>/<sub>8</sub></i>	224	137	21	121
UCT214-43	6,88	<b>68,262</b>	<i>2<sup>11</sup>/<sub>16</sub></i>				
UCT214-44	6,78	<b>69,85</b>	<i>2<sup>3</sup>/<sub>4</sub></i>				
UCT214	6,77	<b>70</b>	–				
UCT215-45	7,45	<b>71,438</b>	<i>2<sup>13</sup>/<sub>16</sub></i>	232	140	21	121
UCT215-46	7,34	<b>73,025</b>	<i>2<sup>7</sup>/<sub>8</sub></i>				
UCT215-47	7,23	<b>74,612</b>	<i>2<sup>15</sup>/<sub>16</sub></i>				
UCT215	7,2	<b>75</b>	–				
UCT215-48	7,12	<b>76,2</b>	<i>3</i>				
UCT216-49	8,27	<b>77,787</b>	<i>3<sup>1</sup>/<sub>16</sub></i>	235	140	21	121
UCT216-50	8,14	<b>79,375</b>	<i>3<sup>1</sup>/<sub>8</sub></i>				
UCT216	8,09	<b>80</b>	–				
UCT216-51	8,01	<b>80,962</b>	<i>3<sup>3</sup>/<sub>16</sub></i>				
UCT217-52	10,8	<b>82,55</b>	<i>3<sup>1</sup>/<sub>4</sub></i>	260	162	29	157
UCT217-53	10,7	<b>84,137</b>	<i>3<sup>5</sup>/<sub>16</sub></i>				
UCT217	10,6	<b>85</b>	–				
UCT217-55	10,4	<b>87,312</b>	<i>3<sup>7</sup>/<sub>16</sub></i>				
UCT218-56	12,37	<b>88,9</b>	<i>3<sup>1</sup>/<sub>2</sub></i>	275	170	30	140
UCT218	12,26	<b>90</b>	–				

										Housing	Radial insert ball bearing
N	N <sub>1</sub>	N <sub>2</sub>	A	H	H <sub>1</sub>	A <sub>1</sub>	B	S <sub>1</sub>	T		
35	25	64	64	146	130	22	55,6	33,4	102	T211	UC211-32
											UC211-33
											UC211-34
											UC211
											UC211-35
35	32	64	64	146	130	22	65,1	39,7	102	T212	UC212-36
											UC212-37
											UC212
											UC212-38
											UC212-39
41	32	70	70	167	151	26	65,1	39,7	111	T213	UC213-40
											UC213
											UC213-41
41	32	70	70	167	151	26	74,6	44,4	111	T214	UC214-42
											UC214-43
											UC214-44
											UC214
41	32	70	70	167	151	26	77,8	44,5	111	T215	UC215-45
											UC215-46
											UC215-47
											UC215
41	32	70	70	184	165	26	82,6	49,3	111	T216	UC216-49
											UC216-50
											UC216
											UC216-51
48	38	73	73	198	173	30	85,7	51,6	124	T217	UC217-52
											UC217-53
											UC217
											UC217-55
47	40	80	80	215	190	28	96	56,3	130	T218	UC218-56
											UC218